

### PRODUCT CODE - SMD CONDUCTIVE POLYMER CAPACITORS

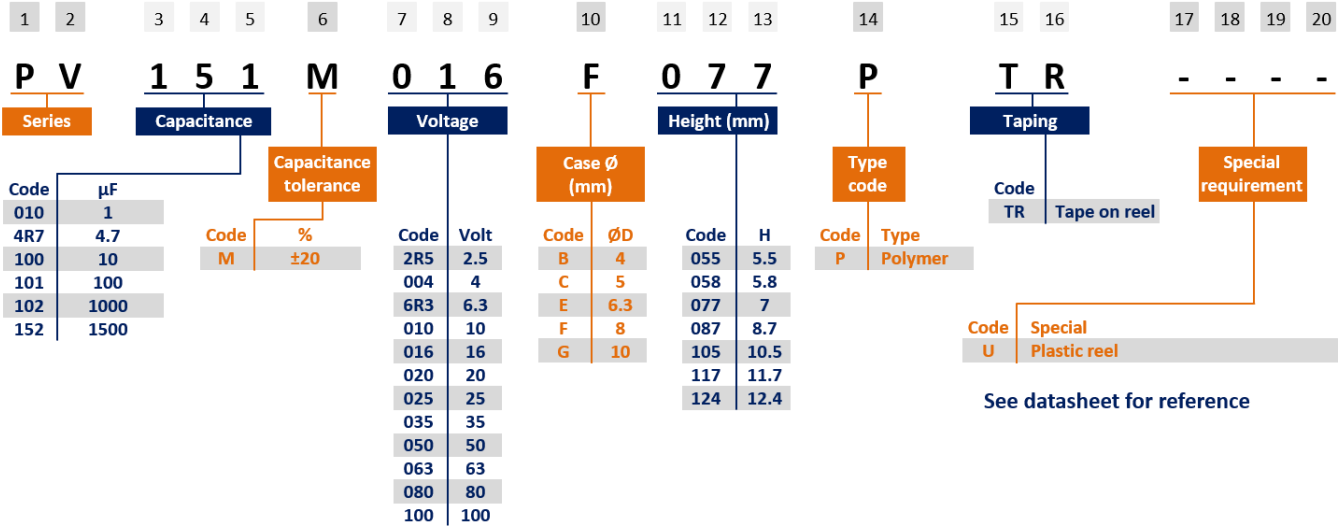

SMD type example:

PV series ▪ 150µF ▪ 16V ▪ ±20% ▪ Ø 8mm ▪ H 7.7mm ▪ Tape & Reel



Please consult CapXon for further assistance

### MARKING - SMD CONDUCTIVE POLYMER CAPACITORS

#### Solid Conductive Polymer Capacitor - SMD type

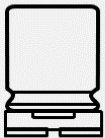

CapXon: Manufacturer trademark  
 150: Nominal capacitance (µF)  
 16V: Rated voltage (V)  
 (-) polarity (Cathode indicate)

PV: PV Series  
 015: Production datacode year/week  
 (ex. 2020/15<sup>th</sup> week)

#### Top view



0 15  
 → Production week  
 → Last digit of the year

### TAPING - SMD CONDUCTIVE POLYMER CAPACITORS - REEL PACK

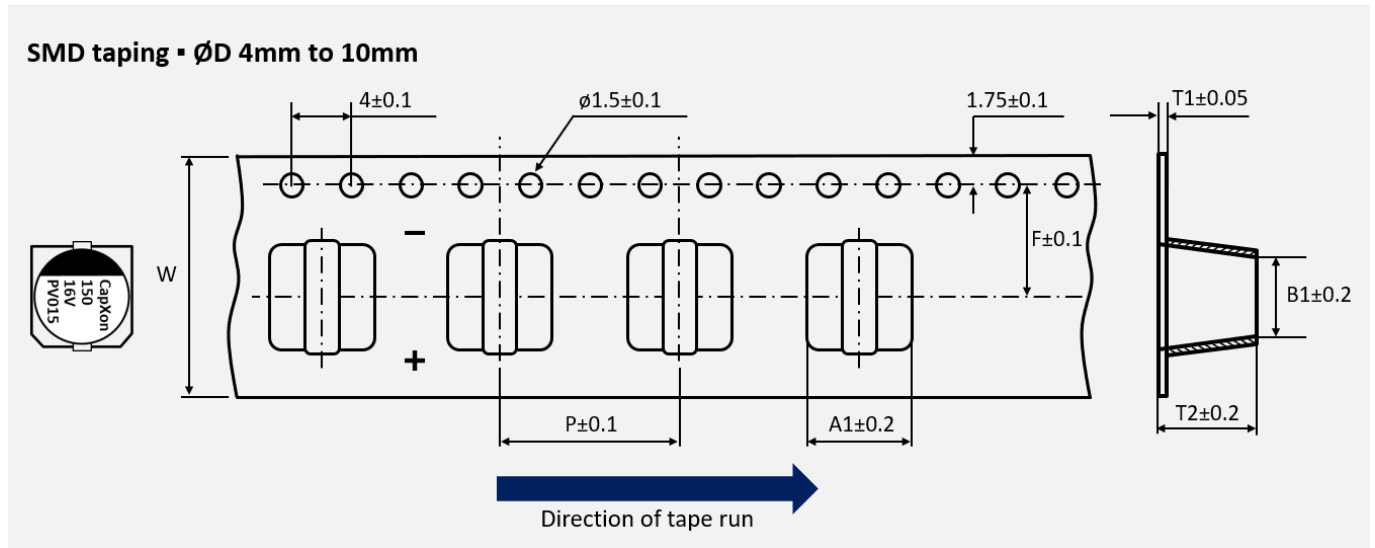

All dimensions in mm

$\varnothing D$	4 x 5.5	5 x 5.5	5 x 5.8	6.3 x 5.8	6.3 x 7.7	8 x 7.7
W	12	12	12	16	16	16
P	8	12	12	12	12	12
F	5.5	5.5	5.5	7.5	7.5	7.5
A1	4.7	5.7	5.7	7	7	8.7
B1	4.7	5.7	5.7	7	7	8.7
T1	0.4	0.4	0.4	0.4	0.4	0.4
T2	5.7	5.7	6.1	6.2	8.1	8.2

$\varnothing D$	8 x 8.7	8 x 10.5	8 x 11.7	10 x 8.7	10 x 10.5	10 x 12.4
W	24	24	24	24	24	24
P	16	16	16	16	16	16
F	11.5	11.5	11.5	11.5	11.5	11.5
A1	8.7	8.7	8.7	10.7	10.7	10.7
B1	8.7	8.7	8.7	10.7	10.7	10.7
T1	0.4	0.4	0.5	0.4	0.4	0.5
T2	11	11	13	11	11	12.9

### TAPING • SMD CONDUCTIVE POLYMER CAPACITORS • REEL PACK • PAPER REEL

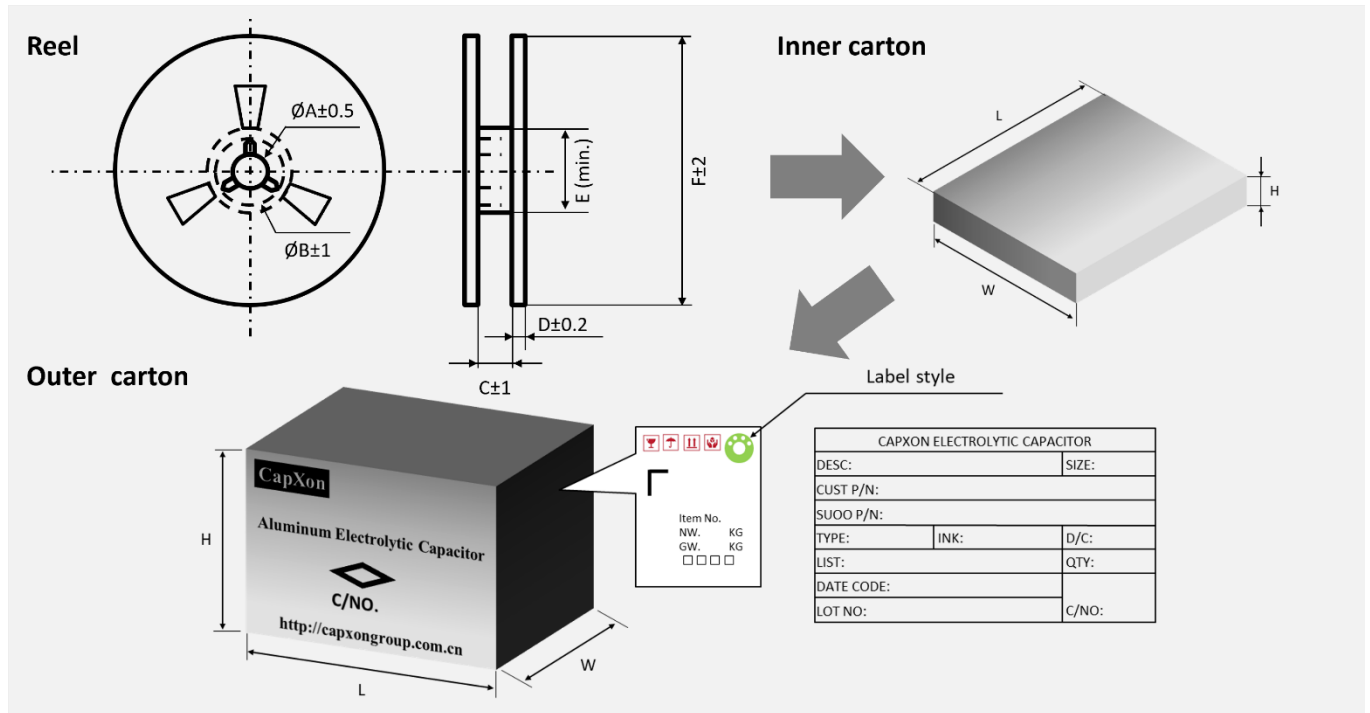

Ø D (mm)	L (mm)	A (mm)	Reel quantity (pcs)	Inner box quantity (pcs)	Inner box size L x W x H (mm)	Outer box quantity (pcs)	Outer box size L x W x H (mm)	Country of origin	Tariff number
4	5.5	14	2000	10000	400 x 390 x 106	30000	425 x 412 x 340	China	85322200
	5.5	14	1000	5000	400 x 390 x 106	15000	425 x 412 x 340	China	85322200
5	5.8	14	1000	5000	400 x 390 x 106	15000	425 x 412 x 340	China	85322200
	5.8	18	1000	4000	400 x 390 x 106	12000	425 x 412 x 340	China	85322200
6.3	7.7	18	900	3600	400 x 390 x 106	10800	425 x 412 x 340	China	85322200
	7.7	18	700	2800	400 x 390 x 106	8400	425 x 412 x 340	China	85322200
8	8.7	18	500	1500	400 x 390 x 106	4500	425 x 412 x 340	China	85322200
	10.5	26	500	1500	400 x 390 x 106	4500	425 x 412 x 340	China	85322200
	11.7	26	400	1200	400 x 390 x 106	3600	425 x 412 x 340	China	85322200
10	8.7	26	500	1500	400 x 390 x 106	4500	425 x 412 x 340	China	85322200
	10.5	26	500	1500	400 x 390 x 106	4500	425 x 412 x 340	China	85322200
	12.4	26	400	1200	400 x 390 x 106	3600	425 x 412 x 340	China	85322200

#### All reel dimensions in mm

Ø D	4	5	5	6.3	6.3	6.3	6.3	8	8	8	8	10	10	10
L	5.5	5.5	5.8	5.5	5.8	6.1	7.7	6.5	7.7	10.5	11.7	8.7	10.5	12.4
A	15	15	15	15	15	15	15	15	15	15	15	15	15	15
B	21	21	21	21	21	21	21	21	21	21	21	21	21	21
C	14	14	14	18	18	18	18	18	18	26	26	26	26	26
D	3	3	3	3	3	3	3	3	3	3	3	3	3	3
E	80	80	80	80	80	80	80	80	80	80	80	80	80	80
F	380	380	380	380	380	380	380	380	380	380	380	380	380	380

Remark: Standard = Paper reel

### TAPING • SMD CONDUCTIVE POLYMER CAPACITORS • REEL PACK • PLASTIC REEL

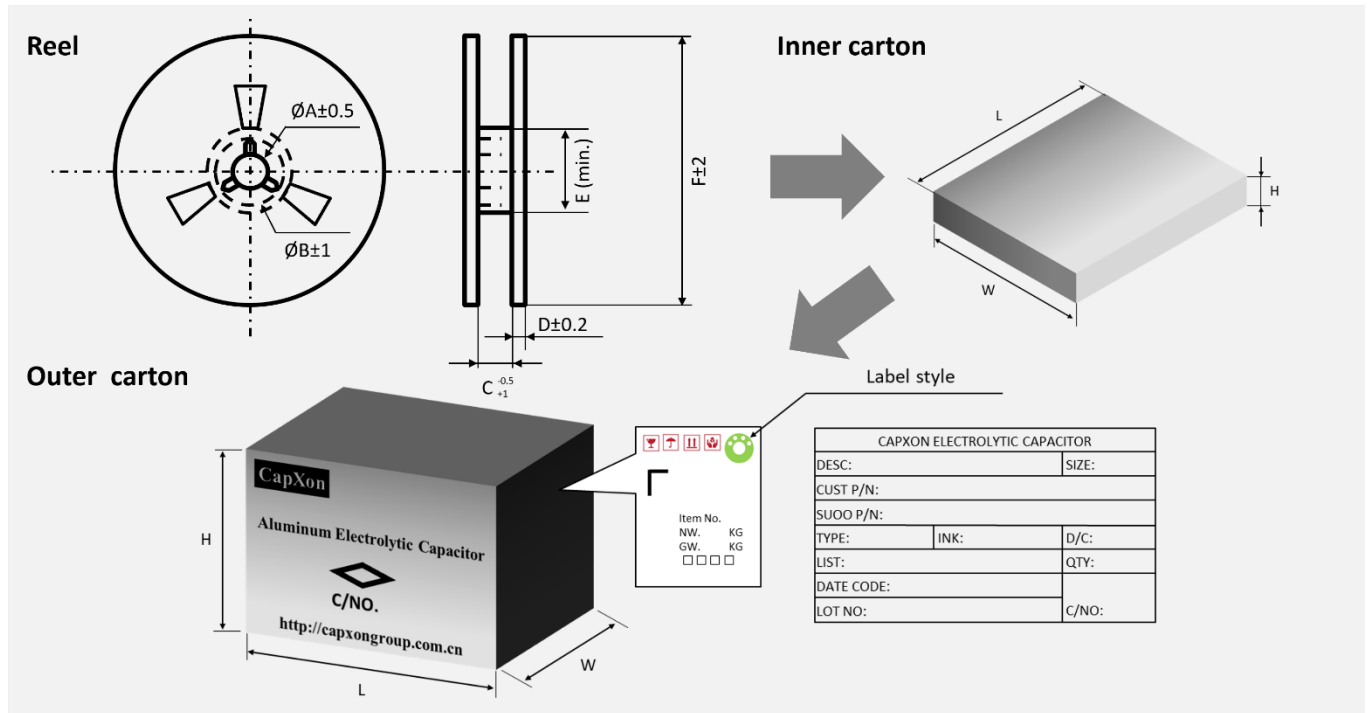

Ø D (mm)	L (mm)	A (mm)	Reel quantity (pcs)	Inner box quantity (pcs)	Inner box size L x W x H (mm)	Outer box quantity (pcs)	Outer box size L x W x H (mm)	Country of origin	Tariff number
4	5.5	14	2000	10000	400 x 390 x 106	30000	425 x 412 x 340	China	85322200
5	5.5	14	1000	5000	400 x 390 x 106	15000	425 x 412 x 340	China	85322200
	5.8	14	1000	5000	400 x 390 x 106	15000	425 x 412 x 340	China	85322200
6.3	5.8	18	1000	4000	400 x 390 x 106	12000	425 x 412 x 340	China	85322200
	7.7	18	900	3600	400 x 390 x 106	10800	425 x 412 x 340	China	85322200
8	7.7	18	700	2800	400 x 390 x 106	8400	425 x 412 x 340	China	85322200
	8.7	18	500	1500	400 x 390 x 106	4500	425 x 412 x 340	China	85322200
	10.5	26	500	1500	400 x 390 x 106	4500	425 x 412 x 340	China	85322200
10	11.7	26	400	1200	400 x 390 x 106	3600	425 x 412 x 340	China	85322200
	8.7	26	500	1500	400 x 390 x 106	4500	425 x 412 x 340	China	85322200
	10.5	26	500	1500	400 x 390 x 106	4500	425 x 412 x 340	China	85322200
	12.4	26	400	1200	400 x 390 x 106	3600	425 x 412 x 340	China	85322200

#### All reel dimensions in mm

Ø D	4	5	5	6.3	6.3	6.3	6.3	8	8	8	8	10	10	10
L	5.5	5.5	5.8	5.5	5.8	6.1	7.7	6.5	7.7	10.5	11.7	8.7	10.5	12.4
A	13.2	13.2	13.2	13.2	13.2	13.2	13.2	13.2	13.2	13.2	13.2	13.2	13.2	13.2
B	21.5	21.5	21.5	21.5	21.5	21.5	21.5	21.5	21.5	21.5	21.5	21.5	21.5	21.5
C	13	13	13	17	17	17	17	25	25	25	25	25	25	25
D	1.5	1.5	1.5	1.5	1.5	1.5	1.5	1.5	1.5	1.5	1.5	1.5	1.5	1.5
E	100	100	100	100	100	100	100	100	100	100	100	100	100	100
F	380	380	380	380	380	380	380	380	380	380	380	380	380	380

Remark: Plastic reel = Add code "U" at the end of the part number

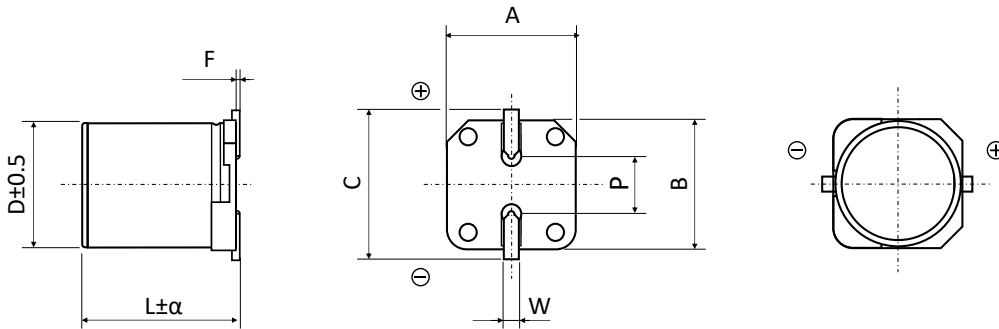
**DIMENSIONS STANDARD PACKAGE** ▪ All dimensions in mm

$\phi D$	L	$\alpha$	$A \pm 0.2$	$B \pm 0.2$	$C \pm 0.2$	F	$P \pm 0.2$	W
4.0	5.5	0.3	4.3	4.3	4.9	0 to 0.3	1.0	0.5 to 0.8
5.0	5.5	0.3	5.3	5.3	5.9	0 to 0.3	1.4	0.5 to 0.8
5.0	5.8	0.3	5.3	5.3	5.9	0 to 0.3	1.4	0.5 to 0.8
6.3	5.8	0.3	6.6	6.6	7.2	0 to 0.3	2.2	0.5 to 0.8
6.3	7.7	0.3	6.6	6.6	7.2	0 to 0.3	2.2	0.5 to 0.8
8.0	7.7	0.3	8.3	8.3	9.0	0 to 0.3	3.1	0.7 to 1.1
8.0	8.7	0.3	8.3	8.3	9.0	0 to 0.3	3.1	0.7 to 1.1
8.0	10.5	0.3	8.3	8.3	9.0	0 to 0.3	3.1	0.7 to 1.1
8.0	11.7	0.3	8.3	8.3	9.0	0 to 0.3	3.1	0.7 to 1.1
10.0	8.7	0.3	10.3	10.3	11.0	0 to 0.3	4.5	0.7 to 1.1
10.0	10.5	0.3	10.3	10.3	11.0	0 to 0.3	4.5	0.7 to 1.1
10.0	12.4	0.3	10.3	10.3	11.0	0 to 0.3	4.5	0.7 to 1.1

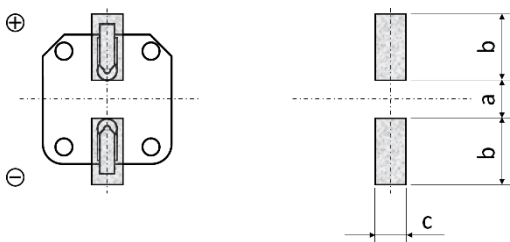
**PAD LAYOUT STANDARD PACKAGE** ▪ All dimensions in mm

$\phi D$	L	a	b	c
4.0	5.5	1.0	2.6	1.6
5.0	5.5	1.4	3.0	1.6
5.0	5.8	1.4	3.0	1.6
6.3	5.8	2.1	3.5	1.6
6.3	7.7	2.1	3.5	1.6
8.0	7.7	2.8	4.2	1.9
8.0	8.7	2.8	4.2	1.9
8.0	10.5	2.8	4.2	1.9
8.0	11.7	2.8	4.2	1.9
10.0	8.7	4.3	4.4	1.9
10.0	10.5	4.3	4.4	1.9
10.0	12.4	4.3	4.4	1.9