

CapXon SW Series

SW Series 5mm 85°C

Features

- ◆ Design for audio equipment.
- ◆ For detail specifications, please refer to Engineering Bulletin NO.E152
- ◆ RoHS Compliant

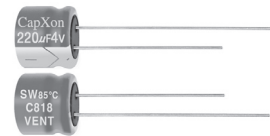

Specifications

Item	Performance Characteristics																								
Operating Temperature Range	-40~+85°C																								
Rated Voltage Range	4~50 VDC																								
Capacitance Range	0.1 to 470 µF																								
Capacitance Tolerance	±20%(120Hz,+20°C)																								
Leakage Current (+20°C,max.)	I=0.01 CV or 3 (µA) (After 2 minute with rated working voltage applied.)																								
Dissipation Factor (tan δ , at 20°C , 120Hz)	<table border="1"> <tr> <td>Working Voltage(VDC)</td> <td>4</td> <td>6.3</td> <td>10</td> <td>16</td> <td>25</td> <td>35</td> <td>50</td> </tr> <tr> <td>D.F.(%)max.</td> <td>35</td> <td>24</td> <td>20</td> <td>16</td> <td>14</td> <td>12</td> <td>10</td> </tr> </table>	Working Voltage(VDC)	4	6.3	10	16	25	35	50	D.F.(%)max.	35	24	20	16	14	12	10								
	Working Voltage(VDC)	4	6.3	10	16	25	35	50																	
D.F.(%)max.	35	24	20	16	14	12	10																		
Low Temperature Characteristics (at 120Hz)	Impedance ratio max																								
	<table border="1"> <tr> <td>Working voltage(VDC)</td> <td>4</td> <td>6.3</td> <td>10</td> <td>16</td> <td>25</td> <td>35</td> <td>50</td> </tr> <tr> <td>Z-25°C / Z+20°C</td> <td>7</td> <td>4</td> <td>3</td> <td>2</td> <td>2</td> <td>2</td> <td>2</td> </tr> <tr> <td>Z-40°C / Z+20°C</td> <td>15</td> <td>8</td> <td>6</td> <td>4</td> <td>4</td> <td>3</td> <td>3</td> </tr> </table>	Working voltage(VDC)	4	6.3	10	16	25	35	50	Z-25°C / Z+20°C	7	4	3	2	2	2	2	Z-40°C / Z+20°C	15	8	6	4	4	3	3
	Working voltage(VDC)	4	6.3	10	16	25	35	50																	
Z-25°C / Z+20°C	7	4	3	2	2	2	2																		
Z-40°C / Z+20°C	15	8	6	4	4	3	3																		
Load Life	Test condition Duration time :1000 Hrs Ambient temperature :+85°C Applied voltage :Rated DC working voltage After test requirement at +20°C Capacitance change : ≤ ±20% of the initial measured value Dissipation factor : ≤ 200% of the initial specified value Leakage current : ≤ The initial specified value																								
Shelf Life	Test condition Duration time :1000 Hrs Ambient temperature :+85°C Applied voltage :None After test requirement at +20°C :Same limits as Load life. Pre-treatment for measurements shall be conducted after application of DC working voltage for 30 minutes.																								

For Audio Equipment

Multiplier for Ripple Current vs. Frequency

CAP(µF) \ (Hz)	50	120	300	1K	10K
Multiplier	0.70	1.00	1.17	1.36	1.50

Diagram of Dimension:(unit:mm)

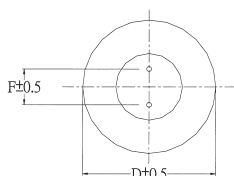
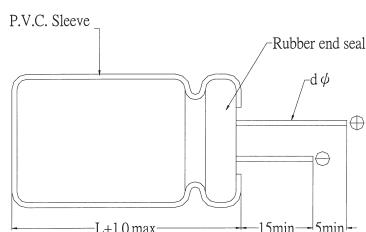

Dψ	4	5	6.3	8
F	1.5	2.0	2.5	3.5
dψ	0.45			0.50

CapXon SW Series

Case Size

φ D×L(mm)

WV(SV) Cap(μF)	4 (5)		6.3 (8)		10 (13)		16 (20)		25 (32)		35 (44)		50 (63)	
	Size	Ripple	Size	Ripple	Size	Ripple	Size	Ripple	Size	Ripple	Size	Ripple	Size	Ripple
0.1													4×5	1.2
0.22													4×5	2.3
0.33													4×5	3.0
0.47													4×5	3.9
1													4×5	7.3
2.2													4×5	11
3.3											4×5	13	4×5	15
4.7									4×5	15	4×5	18	5×5	20
10							4×5	21	5×5	27	5×5	29	6.3×5	31
22			4×5	26	5×5	33	5×5	36	6.3×5	43	6.3×5	46	8×5	52
33	4×5	30	5×5	37	5×5	40	6.3×5	47	6.3×5	52	8×5	62	8×5	70
47	4×5	33	5×5	42	6.3×5	49	6.3×5	58	8×5	70	8×5	81		
100	5×5	54	6.3×5	67	8×5	80	8×5	92	8×5	109				
220	6.3×5	87	8×5	112	8×5	136								
330	8×5	143	8×5	170										
470	8×5	185												

Ripple Current (mA, rms) at 85°C 120Hz