

## SR Series 7mm 85°C

### Features

- ◆ Design for audio equipment.
- ◆ Lineally suited for very compact audio products.
- ◆ For detail specifications, please refer to Engineering Bulletin NO.E151
- ◆ RoHS Compliant

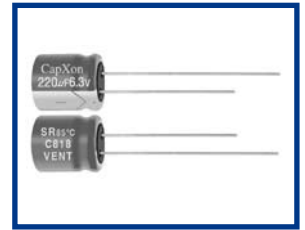

### Specifications

Item	Performance Characteristics																					
Operating Temperature Range	-40~+85°C																					
Rated Voltage Range	6.3~50 VDC																					
Capacitance Range	0.1 to 220 µ F																					
Capacitance Tolerance	±20%(120Hz,+20°C)																					
Leakage Current (+20°C,max.)	I=0.01 CV or 3 (µ A) (After 2 minute with rated working voltage applied.)																					
Dissipation Factor (tan δ , at 20°C , 120Hz)	<table border="1"> <tr> <td>Working Voltage(VDC)</td> <td>6.3</td> <td>10</td> <td>16</td> <td>25</td> <td>35</td> <td>50</td> </tr> <tr> <td>D.F.(%)max.</td> <td>24</td> <td>20</td> <td>16</td> <td>14</td> <td>12</td> <td>10</td> </tr> </table>	Working Voltage(VDC)	6.3	10	16	25	35	50	D.F.(%)max.	24	20	16	14	12	10							
	Working Voltage(VDC)	6.3	10	16	25	35	50															
D.F.(%)max.	24	20	16	14	12	10																
Low Temperature Characteristics (at 120Hz)	Impedance ratio max																					
	<table border="1"> <tr> <td>Working voltage(VDC)</td> <td>6.3</td> <td>10</td> <td>16</td> <td>25</td> <td>35</td> <td>50</td> </tr> <tr> <td>Z-25°C / Z+20°C</td> <td>4</td> <td>3</td> <td>2</td> <td>2</td> <td>2</td> <td>2</td> </tr> <tr> <td>Z-40°C / Z+20°C</td> <td>8</td> <td>6</td> <td>4</td> <td>4</td> <td>3</td> <td>3</td> </tr> </table>	Working voltage(VDC)	6.3	10	16	25	35	50	Z-25°C / Z+20°C	4	3	2	2	2	2	Z-40°C / Z+20°C	8	6	4	4	3	3
	Working voltage(VDC)	6.3	10	16	25	35	50															
Z-25°C / Z+20°C	4	3	2	2	2	2																
Z-40°C / Z+20°C	8	6	4	4	3	3																
Load Life	Test condition Duration time :1000 Hrs Ambient temperature :+85°C Applied voltage :Rated DC working voltage After test requirement at +20°C Capacitance change : ≤ ±20% of the initial measured value Dissipation factor : ≤200% of the initial specified value Leakage current : ≤The initial specified value																					
Shelf Life	Test condition Duration time :1000 Hrs Ambient temperature :+85°C Applied voltage :None After test requirement at +20°C:Same limits as Load life. Pre-treatment for measurements shall be conducted after application of DC working voltage for 30 minutes.																					

### Multiplier for Ripple Current vs. Frequency

CAP(µ F)\Frequency(Hz)	50	120	300	1K	10K
Multiplier	0.70	1.00	1.17	1.36	1.50

### Diagram of Dimension:(unit:mm)

P.E.T Sleeve

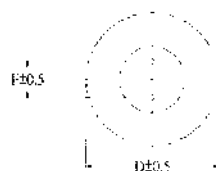

D φ	4	5	6.3
F	1.5	2.0	2.5
d φ	0.45		0.50

## Case Size

φ DxL(mm)

Cap(μF) \ WV(SV)	6.3 (8)		10 (13)		16 (20)		25 (32)		35 (44)		50 (63)	
	Size	Ripple	Size	Ripple	Size	Ripple	Size	Ripple	Size	Ripple	Size	Ripple
0.1											4×7	1.1
0.22											4×7	2.6
0.33											4×7	3.5
0.47											4×7	5.0
1											4×7	10
2.2											4×7	18
3.3											4×7	23
4.7									4×7	23	4×7	26
10					4×7	28	4×7	29	4×7	31	5×7	35
22	4×7	34	4×7	35	4×7	39	5×7	49	5×7	49	6.3×7	58
33	4×7	40	4×7	45	5×7	55	5×7	55	6.3×7	65		
47	4×7	47	5×7	59	5×7	65	6.3×7	71				
100	5×7	76	6.3×7	88	6.3×7	98						
220	6.3×7	124										

Ripple Current ( mA, rms ) at 85°C 120Hz