

AC Series

Part number	AC220M080F105PTR	
Capacitance	22	μF
Voltage	80	VDC
Surge Voltage	100	VDC
Capacitance Tolerance (@120Hz, +20°C)	±20	%
Ripple current (max, @100kHz, +125°C)	1050	mA
Dissipation factor(tanδ @120Hz, +20°C)	8	%
ESR (max, @100kHz, +20°C)	45	mΩ
Leakage Current (max, @ +20°C)*	17.6	μA
Size	8X10.5	mm
Operating temperature	-55 ~ +125	°C
Endurance	4000	h

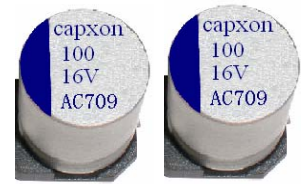

*I≤0.01CV or 3 μA max., whichever is greater
After 2 minutes measured with rated working voltage applied.
AEC-Q200 qualified

Test conditions	Endurance
Duration time	4000h @ 125°C
Applied voltage	Rated DC working voltage
After test requirements (+20°C):	
Capacitance change	≤ ±30% of initial measured value
Dissipation factor change	≤ 200% of the value specified
Leakage current*	≤ the value specified
ESR	≤ 200% of the value specified

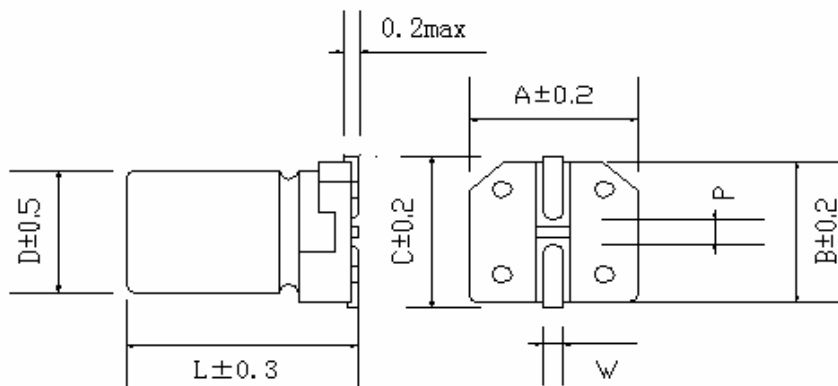

D	L	A	B	C	W	P±0.2
8.0	10.5	8.3	8.3	7.2	0.7~1.1	3.1

Series	Cap	Tol.	Voltage	Case D	Case L	Type	Lead Treatm.	Special
1_2	3_4_5	6	7_8_9	10	11_12_13	14	15_16	17_18_19_20
AC	220	M	080	F	105	P	TR	
	=22μF	=±20%	=80V	=8.0mm	=10.5mm	P=standard	=SMD tape and reel	
			

Specification and description for the component(s) are subject to change without notice. For packaging, handling, precautions and warning information, please visit our website: www.capxongroup.com