

AC Series

Part number	AC220M063E077PTR	
Capacitance	22	μF
Voltage	63	VDC
Surge Voltage	79	VDC
Capacitance Tolerance (@120Hz, +20°C)	±20	%
Ripple current (max, @100kHz, +125°C)	900	mA
Dissipation factor(tanδ @120Hz, +20°C)	8	%
ESR (max, @100kHz, +20°C)	80	mΩ
Leakage Current (max, @ +20°C)*	13.9	μA
Size	6.3X7.7	mm
Operating temperature	-55 ~ +125	°C
Endurance	4000	h

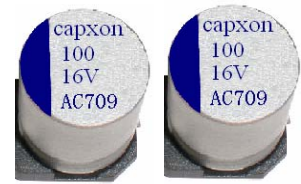

*I≤0.01CV or 3 μA max., whichever is greater
After 2 minutes measured with rated working voltage applied.
AEC-Q200 qualified

Test conditions	Endurance
Duration time	4000h @ 125°C
Applied voltage	Rated DC working voltage
After test requirements (+20°C):	
Capacitance change	≤ ±30% of initial measured value
Dissipation factor change	≤ 200% of the value specified
Leakage current*	≤ the value specified
ESR	≤ 200% of the value specified

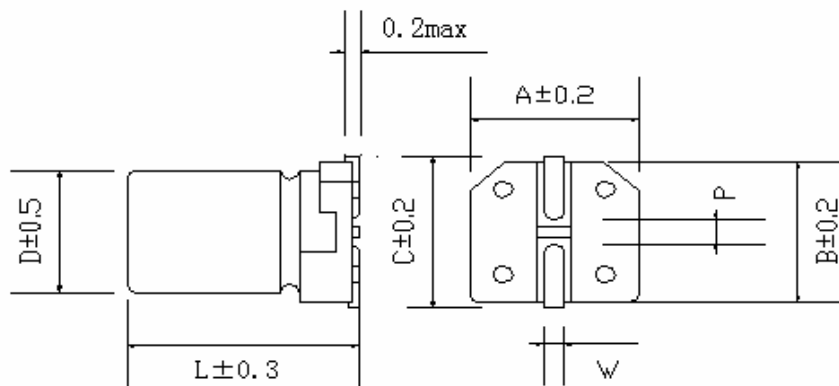

D	L	A	B	C	W	P±0.2
6.3	7.7	6.5	6.5	7.2	0.5~0.8	2.2

Series	Cap	Tol.	Voltage	Case D	Case L	Type	Lead Treatm.	Special
1_2	3_4_5	6	7_8_9	10	11_12_13	14	15_16	17_18_19_20
AC	220	M	063	E	077	P	TR	
	=22μF	=±20%	=63V	=6.3mm	=7.7mm	P=standard	=SMD tape and reel	
			