

AA Series

| | | |
|--|-------------------------|-----|
| Part number | AA330M080G105PTR | |
| Capacitance | 33 | μF |
| Voltage | 80 | VDC |
| Surge Voltage | 100 | VDC |
| Capacitance Tolerance (@120Hz, +20°C) | ±20 | % |
| Ripple current (max, @100kHz, +105°C) | 1700 | mA |
| Dissipation factor(tanδ @120Hz, +20°C) | 8 | % |
| ESR (max, @100kHz, +20°C) | 36 | mΩ |
| Leakage Current (max, @ +20°C)* | 26.4 | μA |
| Size | 10X10.5 | mm |
| Operating temperature | -55 ~ +105 | °C |
| Endurance | 10000 | h |



*I≤0.01CV or 3 μA max., whichever is greater
After 2 minutes measured with rated working voltage applied.

| | |
|----------------------------------|----------------------------------|
| Test conditions | Endurance |
| Duration time | 10000h @ 105°C |
| Applied voltage | Rated DC working voltage |
| After test requirements (+20°C): | |
| Capacitance change | ≤ ±30% of initial measured value |
| Dissipation factor change | ≤ 200% of the value specified |
| Leakage current* | ≤ the value specified |
| ESR | ≤ 200% of the value specified |

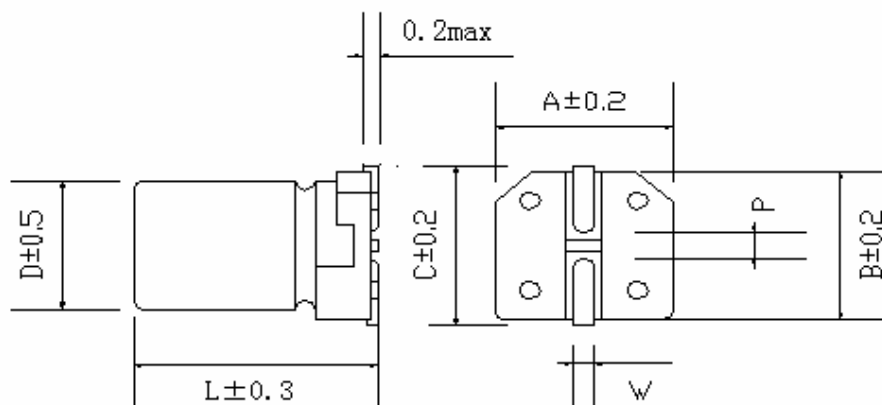

| | | | | | | |
|------|------|------|------|-----|---------|-------|
| D | L | A | B | C | W | P±0.2 |
| 10.0 | 10.5 | 10.3 | 10.3 | 7.2 | 0.7~1.1 | 4.5 |

| Series | Cap | Tol. | Voltage | Case D | Case L | Type | Lead Treatm. | Special |
|-----------|------------|----------|------------|----------|------------|------------|--------------------|-------------|
| 1_2 | 3_4_5 | 6 | 7_8_9 | 10 | 11_12_13 | 14 | 15_16 | 17_18_19_20 |
| AA | 330 | M | 080 | G | 105 | P | TR | |
| | =33μF | =±20% | =80V | =10.0mm | =10.5mm | P=standard | =SMD tape and reel | |
| | | | | | | | | |
| | ... | .. | | ... | ... | | | |