

**AA Series**

|  |                         |     |
|--|-------------------------|-----|
| Part number                            | <b>AA220M050E058PTR</b> |     |
| Capacitance                            | 22                      | μF  |
| Voltage                                | 50                      | VDC |
| Surge Voltage                          | 63                      | VDC |
| Capacitance Tolerance (@120Hz, +20°C)  | ±20                     | %   |
| Ripple current (max, @100kHz, +105°C)  | 1100                    | mA  |
| Dissipation factor(tanδ @120Hz, +20°C) | 10                      | %   |
| ESR (max, @100kHz, +20°C)              | 80                      | mΩ  |
| Leakage Current (max, @ +20°C)*        | 11.0                    | μA  |
| Size                                   | 6.3X5.8                 | mm  |
| Operating temperature                  | -55 ~ +105              | °C  |
| Endurance                              | 10000                   | h   |



\*I≤0.01CV or 3 μA max., whichever is greater  
After 2 minutes measured with rated working voltage applied.

|                                  |                                  |
|----------------------------------|----------------------------------|
| Test conditions                  | Endurance                        |
| Duration time                    | 10000h @ 105°C                   |
| Applied voltage                  | Rated DC working voltage         |
| After test requirements (+20°C): |                                  |
| Capacitance change               | ≤ ±30% of initial measured value |
| Dissipation factor change        | ≤ 200% of the value specified    |
| Leakage current*                 | ≤ the value specified            |
| ESR                              | ≤ 200% of the value specified    |

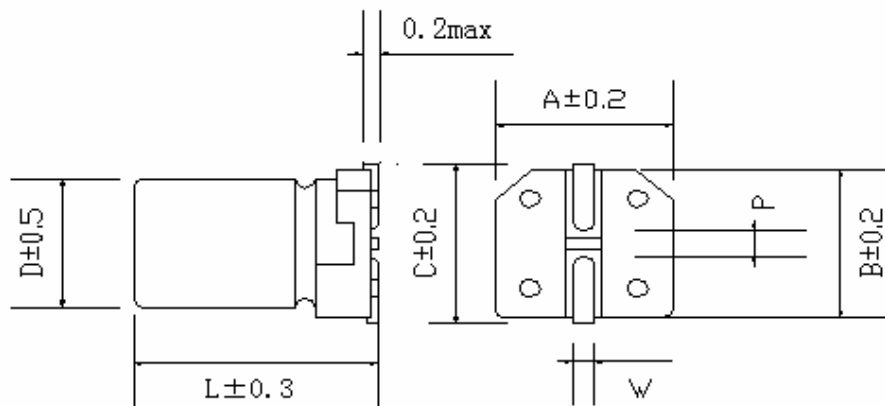

|     |     |     |     |     |         |       |
|-----|-----|-----|-----|-----|---------|-------|
| D   | L   | A   | B   | C   | W       | P±0.2 |
| 6.3 | 5.8 | 6.5 | 6.5 | 7.2 | 0.5~0.8 | 2.2   |

| Series    | Cap        | Tol.     | Voltage    | Case D   | Case L     | Type       | Lead Treatm.       | Special     |
|-----------|------------|----------|------------|----------|------------|------------|--------------------|-------------|
| 1_2       | 3_4_5      | 6        | 7_8_9      | 10       | 11_12_13   | 14         | 15_16              | 17_18_19_20 |
| <b>AA</b> | <b>220</b> | <b>M</b> | <b>050</b> | <b>E</b> | <b>058</b> | <b>P</b>   | <b>TR</b>          |             |
|           | =22μF      | =±20%    | =50V       | =6.3mm   | =5.8mm     | P=standard | =SMD tape and reel |             |
|           |            |          |            |          |            |            |                    |             |
|           | ...        | ..       |            | ...      | ...        |            |                    |             |