

AA Series

Part number	AA220M035C058PTR	
Capacitance	22	μF
Voltage	35	VDC
Surge Voltage	44	VDC
Capacitance Tolerance (@120Hz, +20°C)	±20	%
Ripple current (max, @100kHz, +105°C)	900	mA
Dissipation factor(tanδ @120Hz, +20°C)	12	%
ESR (max, @100kHz, +20°C)	100	mΩ
Leakage Current (max, @ +20°C)*	7.7	μA
Size	5X5.8	mm
Operating temperature	-55 ~ +105	°C
Endurance	10000	h



*I≤0.01CV or 3 μA max., whichever is greater
After 2 minutes measured with rated working voltage applied.

Test conditions	Endurance
Duration time	10000h @ 105°C
Applied voltage	Rated DC working voltage
After test requirements (+20°C):	
Capacitance change	≤ ±30% of initial measured value
Dissipation factor change	≤ 200% of the value specified
Leakage current*	≤ the value specified
ESR	≤ 200% of the value specified

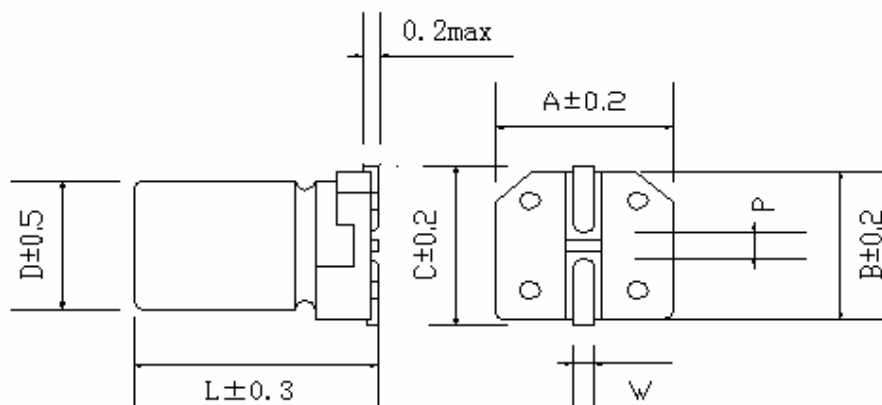

D	L	A	B	C	W	P±0.2
5.0	5.8	5.3	5.3	5.9	0.5~0.8	1.4

Series	Cap	Tol.	Voltage	Case D	Case L	Type	Lead Treatm.	Special
1_2	3_4_5	6	7_8_9	10	11_12_13	14	15_16	17_18_19_20
AA	220	M	035	C	058	P	TR	
	=22μF	=±20%	=35V	=5.0mm	=5.8mm	P=standard	=SMD tape and reel	
			