

**AA Series**

Part number	<b>AA151M035F105PTR</b>	
Capacitance	150	μF
Voltage	35	VDC
Surge Voltage	44	VDC
Capacitance Tolerance (@120Hz, +20°C)	±20	%
Ripple current (max, @100kHz, +105°C)	2300	mA
Dissipation factor(tanδ @120Hz, +20°C)	12	%
ESR (max, @100kHz, +20°C)	27	mΩ
Leakage Current (max, @ +20°C)*	52.5	μA
Size	8X10.5	mm
Operating temperature	-55 ~ +105	°C
Endurance	10000	h



\*I≤0.01CV or 3 μA max., whichever is greater  
After 2 minutes measured with rated working voltage applied.

Test conditions	Endurance
Duration time	10000h @ 105°C
Applied voltage	Rated DC working voltage
After test requirements (+20°C):	
Capacitance change	≤ ±30% of initial measured value
Dissipation factor change	≤ 200% of the value specified
Leakage current*	≤ the value specified
ESR	≤ 200% of the value specified

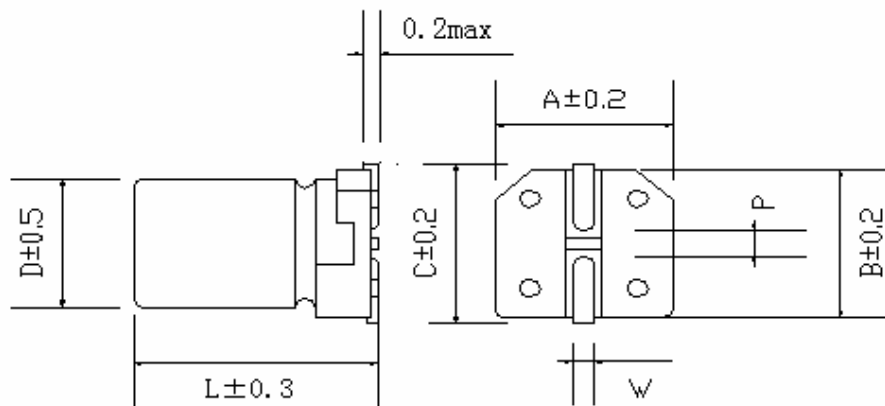

D	L	A	B	C	W	P±0.2
8.0	10.5	8.3	8.3	9.0	0.7~1.1	3.1

Series	Cap	Tol.	Voltage	Case D	Case L	Type	Lead Treatm.	Special
1_2	3_4_5	6	7_8_9	10	11_12_13	14	15_16	17_18_19_20
<b>AA</b>	<b>151</b>	<b>M</b>	<b>035</b>	<b>F</b>	<b>105</b>	<b>P</b>	<b>TR</b>	
	=150μF	=±20%	=35V	=8.0mm	=10.5mm	P=standard	=SMD tape and reel	
	...	..		...	...			