

**AA Series**

Part number	<b>AA100M063E058PTR</b>	
Capacitance	10	μF
Voltage	63	VDC
Surge Voltage	79	VDC
Capacitance Tolerance (@120Hz, +20°C)	±20	%
Ripple current (max, @100kHz, +105°C)	1000	mA
Dissipation factor(tanδ @120Hz, +20°C)	8	%
ESR (max, @100kHz, +20°C)	120	mΩ
Leakage Current (max, @ +20°C)*	6.3	μA
Size	6.3X5.8	mm
Operating temperature	-55 ~ +105	°C
Endurance	10000	h



\*I≤0.01CV or 3 μA max., whichever is greater  
After 2 minutes measured with rated working voltage applied.

Test conditions	Endurance
Duration time	10000h @ 105°C
Applied voltage	Rated DC working voltage
After test requirements (+20°C):	
Capacitance change	≤ ±30% of initial measured value
Dissipation factor change	≤ 200% of the value specified
Leakage current*	≤ the value specified
ESR	≤ 200% of the value specified

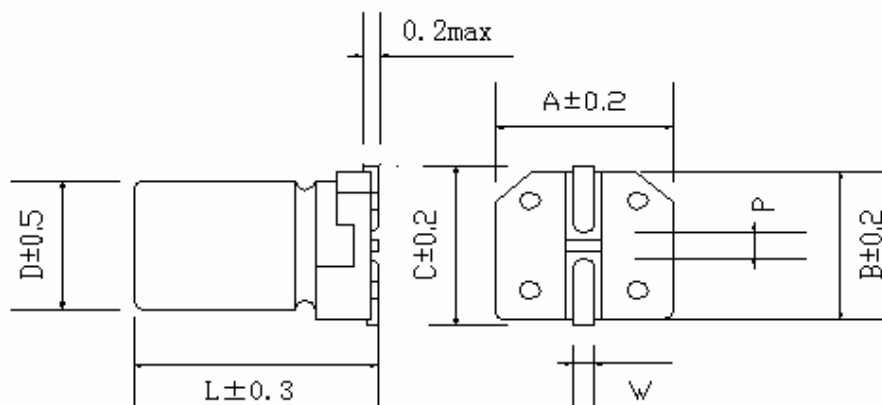

D	L	A	B	C	W	P±0.2
6.3	5.8	6.5	6.5	7.2	0.5~0.8	2.2

Series	Cap	Tol.	Voltage	Case D	Case L	Type	Lead Treatm.	Special
1_2	3_4_5	6	7_8_9	10	11_12_13	14	15_16	17_18_19_20
<b>AA</b>	<b>100</b>	<b>M</b>	<b>063</b>	<b>E</b>	<b>058</b>	<b>P</b>	<b>TR</b>	
	=10μF	=±20%	=63V	=6.3mm	=5.8mm	P=standard	=SMD tape and reel	
	...	..		...	...			